

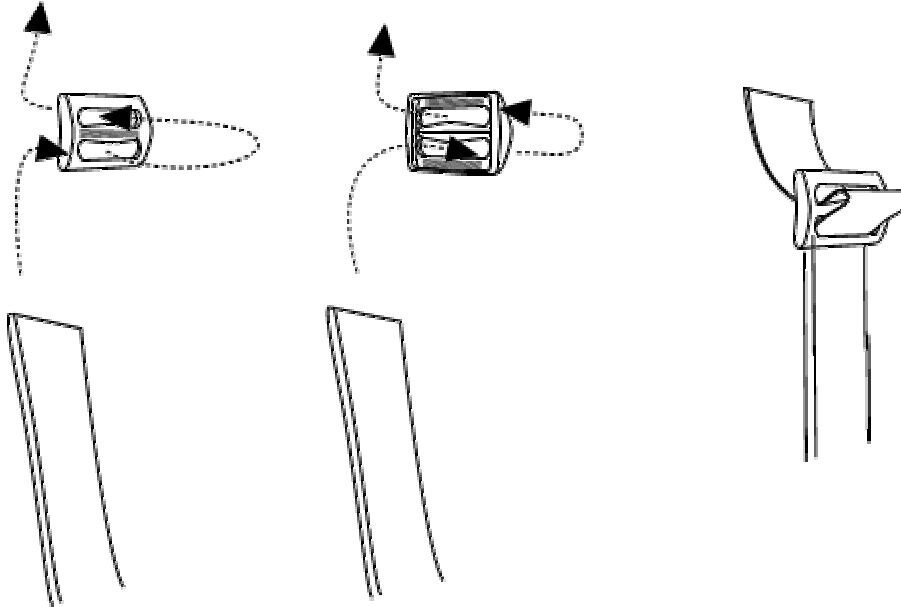

Recoil Buckle Adjustment

Step 1- Feed the recoil belt through the recoil belt buckle as shown.



Step 2- Feed the loose end of the recoil belt through the d-ring and feed it back on itself through the recoil buckle as shown. Once complete, you may wish to return the loose end of the recoil belt back through the recoil belt buckle for neatness.

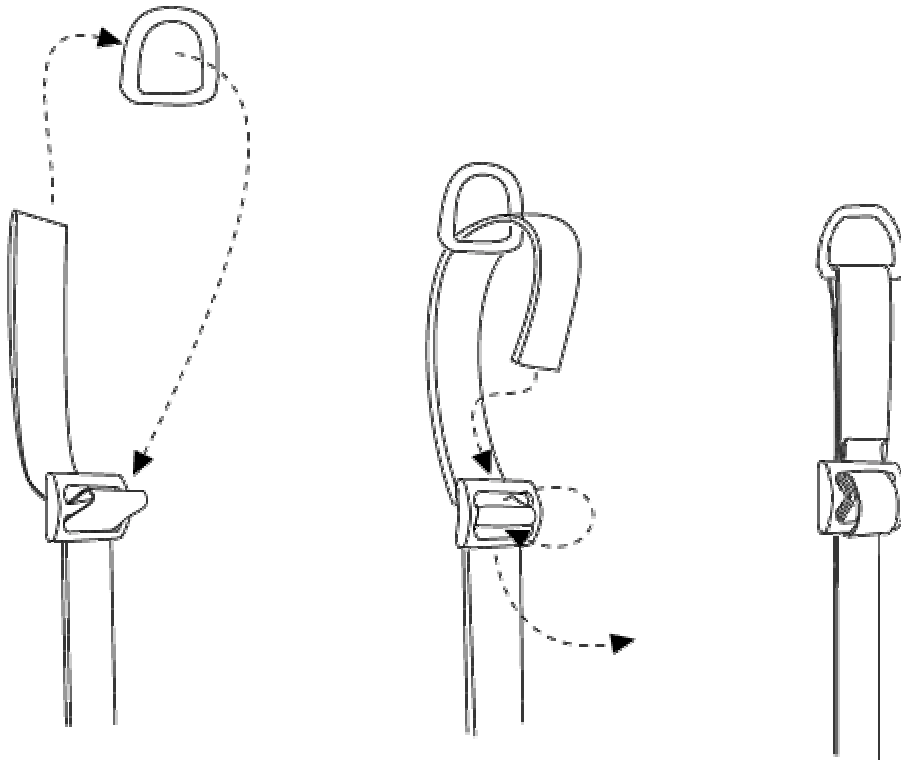

WaterRower

Europe: 5 Goldhawk Estate, Brackenbury Road, London, W6 0BA, Tel: 0181 749 8400 Fax: 0181 749 8600

Internet: www.waterrower.co.uk email: support@waterrower.co.uk

America: 30 Cutler Street, Warren, RI 02885, Tel: 401 247 7742, Fax: 401 247 7743

Internet: www.waterrower.com, email: support@waterrower.com