

DISASSEMBLY INSTRUCTIONS: WOODEN DUAL RAIL WATERROWER

PREP WHAT YOU'LL NEED...

Bucket



Syphon Pump



Plastic Bag



Rubber Band



Card



Ziplock Bag



Allen Key(s)



PREP DRAIN THE WATER FROM YOUR TANK

Remove the tank stopper. Use the provided syphon pump to remove the water from your tank. There will be approximately ½ cup of water left in the tank.

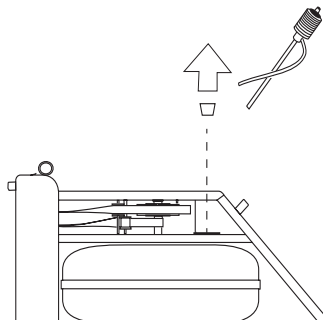

Place a plastic bag over the tank opening and insert tank stopper over the plastic bag.

This step is important to ensure the remaining water does not leak out of the tank during shipping causing damage and/or mold to the rower.

STEP 1

(A) Stand the WaterRower upright. Unclip the bungee from the recoil belt. (B) Pull the handle to the forward riser while pulling the recoil belt through the other side. Using an elastic band, secure the handle to the top deck (Band goes around one end of the handle, under the top deck, and then over the other end of the handle). (C) Wrap the recoil belt around the forward riser bracket. Tuck the end of the recoil belt through itself and pull tight to secure.

A

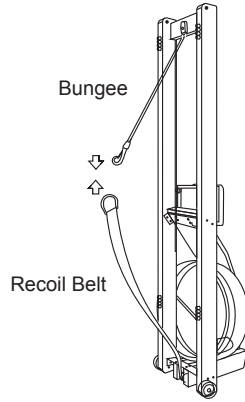
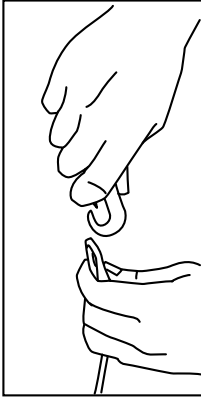

B

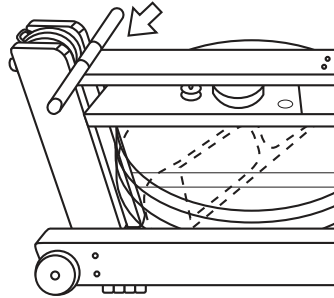
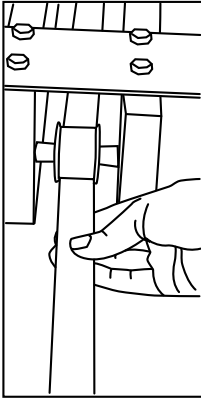

C

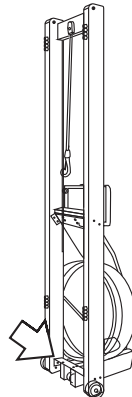
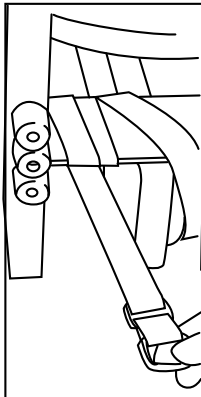

STEP 2

Remove the JCN Nuts and JCB Bolts attaching the footboard to the rails (i). Lay the rower back down, footboard still attached.

JCN Nut
(x4)



JCB Bolt
(x4)

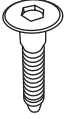

Allen Key(s)

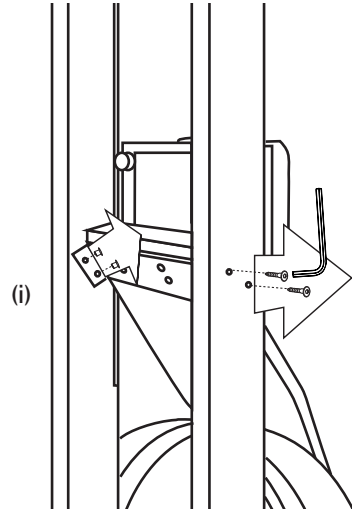
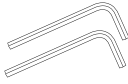

STEP 3

Press the heel rest adjustment button (i) and pull down the Footpads (ii) to remove. It may be required to slide a card between the footpad cover and the top of the footpads to allow the pads to slide under the cover to remove.

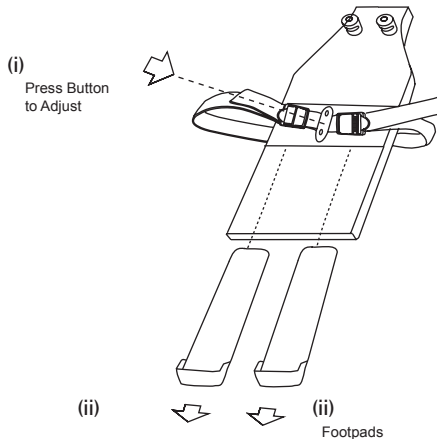

STEP 4

Unscrew and remove the Handle Rests (i). Remove the footboard. It may be necessary to slightly loosen the two bolts on the Top Deck (ii) to remove the footboard. **DO NOT COMPLETELY REMOVE THE TOP DECK BOLTS**

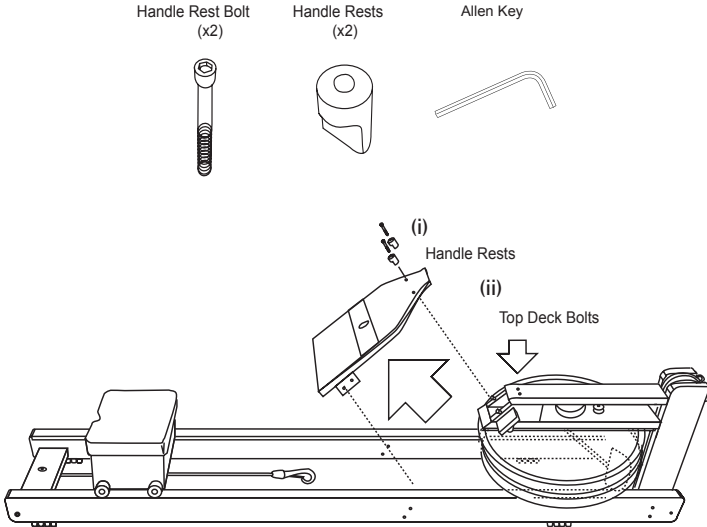

STEP 5

Remove the JCN Nuts and JCB Bolts attaching the tank assembly to the rails at (i) & (ii). Remove the tank assembly from the rails. **DO NOT** disassemble the forward riser or top deck from the tank.

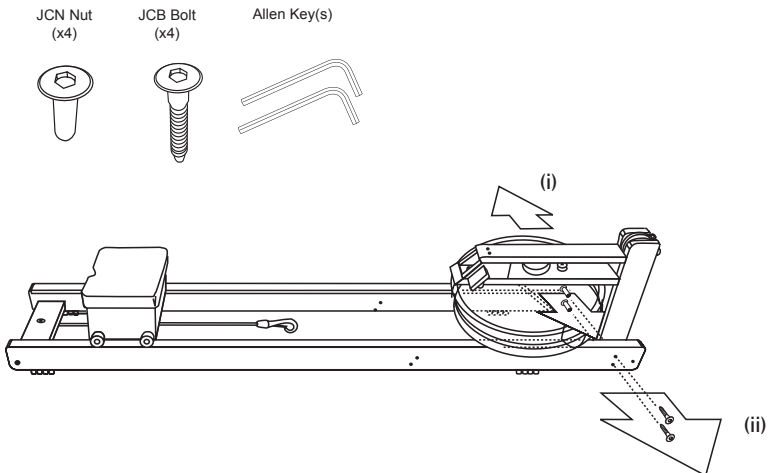

STEP 6

Remove the dolly wheels from the rails using the allen key.

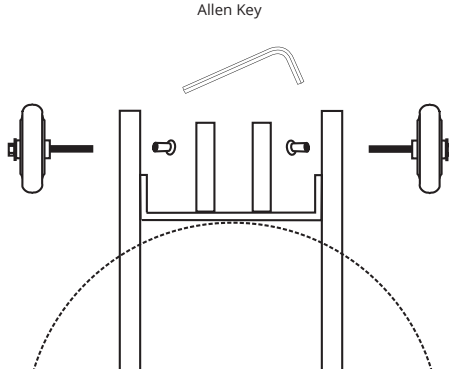

STEP 7

Remove the seat assembly.

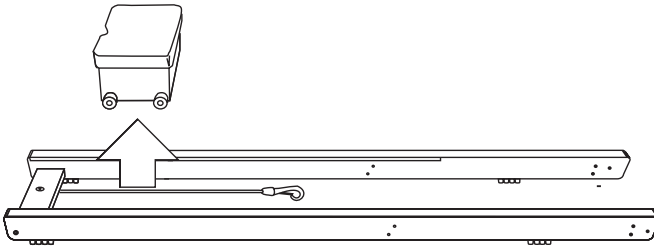

STEP 8

Disconnect the Rear Spacer (i) by removing the female JCN nuts using the Allen key. Wrap the bungee around the rear spacer and tie it off within itself. Place all bolts, handle rests, and dolly wheels in a plastic bag for shipping.

